

04/2014

Mod: **BIG FOOD/SS**

Production code: **PANINI XL EMAIL**



Diamond
catering equipment



PANINI XL LISSE EMAILLE

Vue 3D

DT01

Date :
24/04/2014

Dessiné par :
C.Gu

Approuvé par :
R.Schoenberger

Date :
24/04/2014

Indice
A

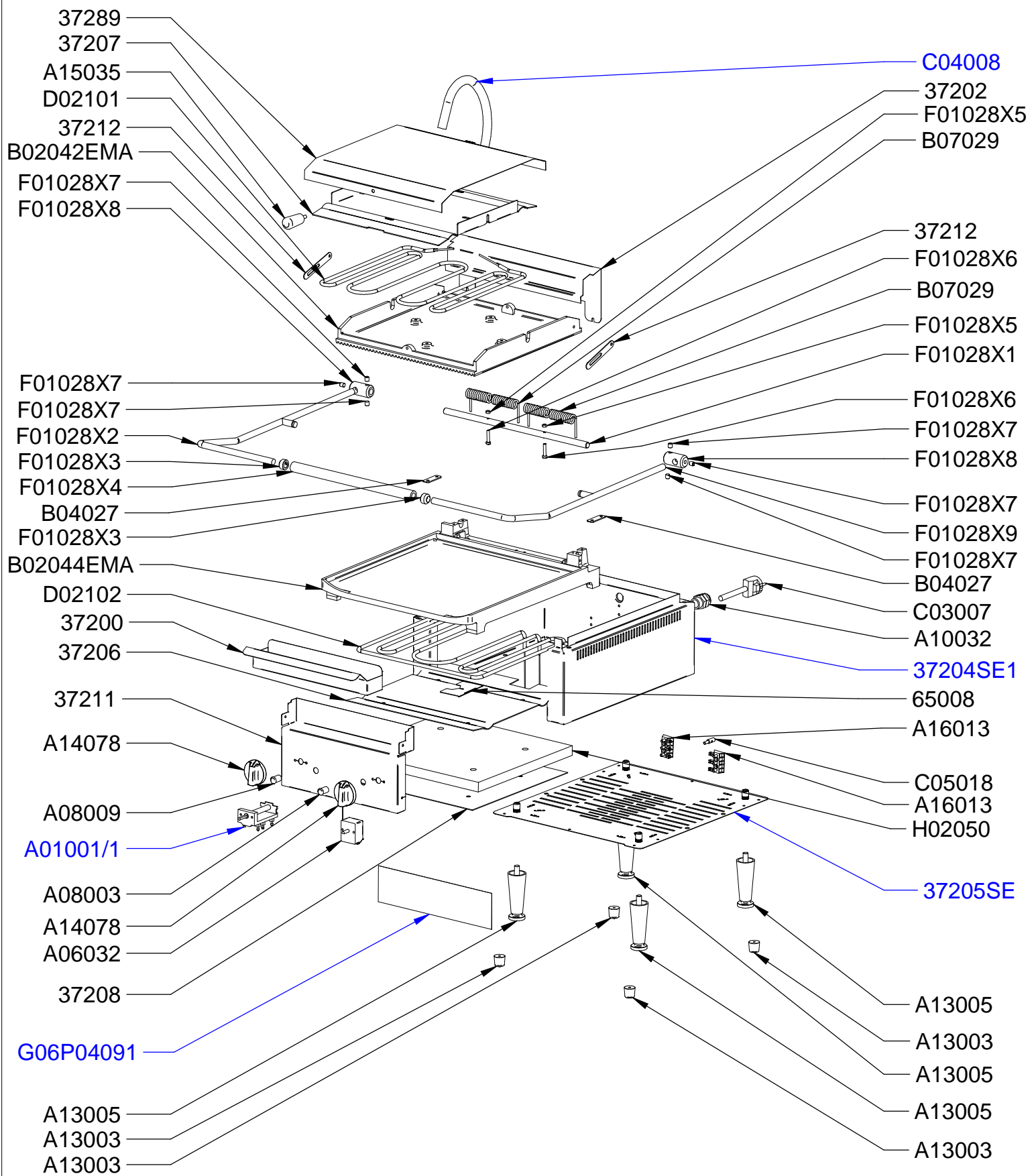

PANINI XL LISSE EMAILLE

Vue éclatée

DT01

Date :
24/04/2014

Dessiné par :
C.Gu

Approuvé par :
S.Grenon

Date :
24/04/2014

Indice
A

| CODE | QTE | PIECE | SPARE PART |
|-----------|-----|--|---|
| 37200 | 1 | BAC A SAUCE PANINI XL | SAUCE LID PANINI XL |
| 37202 | 1 | CACHE RESSORT PANINI XL | SPRING PROTECTION PANINI XL |
| 37204SE1 | 1 | S/E CEINTURE PANINI XL | CASING PANINI XL |
| 37205SE | 1 | FOND SOCLE PANINI XL | BOTTOM CASING PANINI XL |
| 37206 | 1 | SERRE REISTANCE INF PANINI XL | LOWER HEATING ELEMENT HOLDER PANINI XL |
| 37207 | 1 | SERRE RESISTANCE SUP PANINI XL | UPPER HEATING ELEMENT HOLDER PANINI XL |
| 37208 | 1 | DEFLECTEUR PANINI XL | DEFLECTOR PANINI XL |
| 37211 | 1 | BANDEAU INVERSE PANINI XL | REVERSED CONTROL PANEL PANINI XL |
| 37212 | 2 | GUIDE PLAQUE SUPERIEURE PANINI XL | TOP PLATE GUIDE PANINI XL |
| 37289 | 1 | CAPOT INOX | STAINLESS STEEL COVER |
| 65008 | 1 | SUPPORT BULBE THERMOSTAT | THERMOSTAT HOLDER |
| A01001/1 | 1 | COMMUTATEUR 4924215001 PSM 60 | COMMUTATOR 4924215001 |
| A06032 | 1 | THERMOSTAT CONTACT GRILL/TQ | THERMOSTAT CONTACT GRILL/TQ |
| A08003 | 1 | VOYANT ORANGE DIAM 12 UL | ORANGE PILOT LIGHT DIAM 12 UL |
| A08009 | 1 | VOYANT VERT 230V UL | GREEN PILOT LIGHT 230V UL |
| A10032 | 1 | PRESSE ETOUPE IP68 EPN 250/KV PG 16 RF14 | CORD CLOSER IP68 EPN 250/KV PG 16 RF14 |
| A13003 | 4 | PIED CAOUTCHOUC PZ, CV, MR26 | RUBBER FOOT PZ, CV, MR26 |
| A13005 | 4 | PIED REGLABLE RBE4,RF14 | ADJUSTMENT FOOT RBE4, RF14 |
| A14078 | 2 | BOULTON 12 H CREPIERE SHOARMA ELECT | KNOB 12 H FOR ELECTRIC CREPE MACHINE GRE |
| A15035 | 1 | POIGNEE C.G. I280/40P M 6X16 | HANDLE CONTACT GRILL |
| A16013 | 2 | BORNIER 3 PLOTS CONTACT GRILL | 3 HOLES DOMINO |
| B02042EMA | 1 | PLAQUE FONTE PANINI XL SUP RAINUREE EMAILLEE | TOP ENAMELLED GROOVED CAST IRON PLATE PANINI XL |
| B02044EMA | 1 | FONTE PANINI XL INFERIEURE LISSE EMAILLEE | BOTTOM ENAMELLED FLAT CAST IRON PLATE PANINI XL |
| B04027 | 2 | BRIDE POIGNEE PANINI XL | HANDLE STRAP PANINI XL |
| B07029 | 2 | RESSORT DOUBLE TORSION INOX PANINI - ANGLE 90° | SPRING PANINI |
| C03007 | 1 | CORDON H07 RNF 3x1.5 GG/RF FD | CORD H07 RNF 3x1.5 GG/RF FD |
| C04008 | 1 | GAINÉ RESSORT LG 350 MM PANINI/MAJESTIC VITRO | SPRING GIRDLE LG 350 MM VITRO |
| C05018 | 1 | BORNE EQUIPOTENTIEL | EQUIPOTENTIAL TERMINAL |
| D02101 | 1 | RESISTANCE SUP PANINI XL 1400 W 230 V | TOP HEATING ELEMENT PANINI XL 1400 W 230 V |
| D02102 | 1 | RESISTANCE INFERIEURE PANINI XL 2200 W 230 V | BOTTOM HEATING ELEMENT PANINI XL 2200 W 230 V |
| F01028 | 1 | POIGNEE COMPLETE PANINI XL | HANDLE ASSEMBLY PANINI XL |
| F01028X1 | 1 | AXE POIGNEE PANINI XL | HANDLE AXLE PANINI XL |
| F01028X2 | 1 | POIGNEE GAUCHE PANINI XL | LEFT HANDLE PANINI XL |
| F01028X3 | 2 | BAGUE POIGNEE PANINI XL | HANDLE RING PANINI XL |
| F01028X4 | 1 | POIGNEE PANINI XL | HANDLE PANINI XL |
| F01028X5 | 2 | ECROU POIGNEE PANINI XL | HANDLE NUT PANINI XL |
| F01028X6 | 2 | VIS M5 POIGNEE PANINI XL | HANDLE SCREW M5 PANINI XL |
| F01028X7 | 6 | VIS M8 POIGNEE PANINI XL | HANDLE SCREW M8 PANINI XL |
| F01028X8 | 2 | BLOCAGE POIGNEE PANINI XL | HANDLE LOCK PANINI XL |
| F01028X9 | 1 | POIGNEE DROITE PANINI XL | RIGHT HANDLE PANINI XL |
| G06P04091 | 1 | CADRAN | FRONT PANEL |
| H02050 | 1 | ISOLANT INFERIEUR PANINI XL | LOWER INSULATION PANINI XL |

PANINI XL LISSE EMAILLE

Nomenclature

DT01

Date :
24/04/2014

Dessiné par :
C.Gu

Approuvé par :
J.Godéré

Date :
24/04/2014

Indice
A

| | |
|--------------------|-----------------------------|
| Produit concerné : | |
| Code | Cadran / Front panel |
| P04091D02 | G06448 |

PANINI XL LISSE EMAILLE

Cadran

DT01

Date :
24/04/2014

Dessiné par :
C.Gu

Approuvé par :
J.Godéré

Date :
10/04/2014

Indice
A